

THESE 200 NATURE ACRES  
INSPIRED DR. FOSS'S BOOK

# "SWAN VALLEY JOURNAL"



Please note: The data contained herein was obtained from the owner and other reliable sources deemed reliable, but is not guaranteed. Prospective buyers are advised to check the facts to their own satisfaction.



## SWAN RIVER VALLEY REAL ESTATE

7217 HWY 83 N (Located in the Mission Mountains Mercantile Building)  
P.O. Box 1111 SWAN VALLEY, Condon, Montana 59826



Len Kobylenski, Broker Swan Valley Office  
Phone 406.754.2233 Fax 406.754.2826  
Residential - Recreational - Investment

Website: [swanvalley.com](http://swanvalley.com) Email: [len@swanvalley.com](mailto:len@swanvalley.com)



# 200 NATURE ACRES

## THE HOMESTEAD

A Montana Classic!  
Log cabin featuring a massive river rock fireplace. Warm pine accents are found throughout the furnished home. Enjoy for weekend retreats, or as a home base while you build your Montana dream home. The cabin overlooks a scenic meadow and miles of rugged Mission Mountains to the west.

In The backyard the Swan Range provides a backdrop for one of the many wildlife ponds.

One main bedroom & bath + loft overlooking the great room  
Full walk-out basement great for shop work, storage & . . .

*\* Includes Nature Conservancy conservation easement allowing for a total of three homes on this 200 acre parcel. Easement details are available upon request .*



Please note: The data contained herein was obtained from the owner and other reliable sources deemed reliable, but is not guaranteed. Prospective buyers are advised to check the facts to their own satisfaction.



## SWAN RIVER VALLEY REAL ESTATE

7217 HWY 83 N (Located in the Mission Mountains Mercantile Building)  
P.O. Box 1111 SWAN VALLEY, Condon , Montana 59826



Len Kobylenski, Broker - Swan Valley Office  
Phone 406.754.2233 Fax 406.754.2826  
Residential - Recreational - Investment

Website: [swanvalley.com](http://swanvalley.com) Email: [len@swanvalley.com](mailto:len@swanvalley.com)



# 200 NATURE ACRES

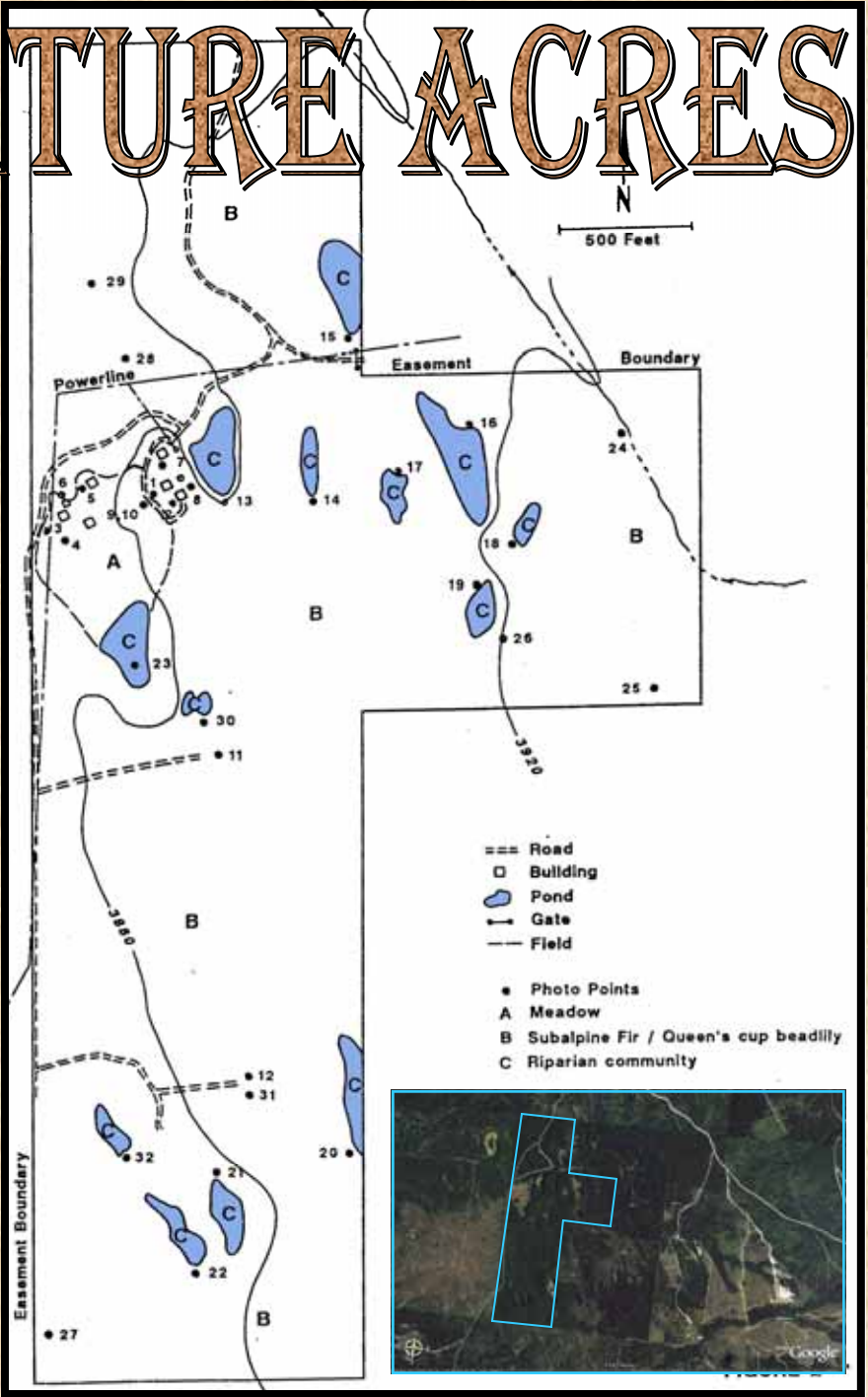

Please note: The data contained herein was obtained from the owner and other reliable sources deemed reliable, but is not guaranteed. Prospective buyers are advised to check the facts to their own satisfaction.

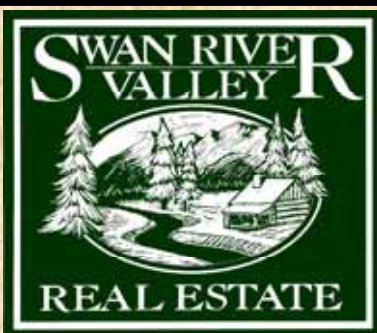

## SWAN RIVER VALLEY REAL ESTATE

7217 HWY 83 N (Located in the Mission Mountains Mercantile Building)  
 P.O. Box 1111 SWAN VALLEY, Condon, Montana 59826



REALTOR  
 MLS

Broker : Len Kobylenski - Swan Valley Office  
 Phone 406.754.2233 Fax 406.754.2826

Website: [swanvalley.com](http://swanvalley.com) Email: [len@swanvalley.com](mailto:len@swanvalley.com)



# 200 NATURE ACRES

ENJOY TWO  
WILDERNESS AREAS

WEST  
MISSION MOUNTAINS  
WILDERNESS

Wilderness trailheads  
Are scattered throughout the  
Mission Mountains. USFS roads  
provide access to these trails

EAST  
BOB MARSHALL  
WILDERNESS

The most popular trailhead in  
the Swan into the Bob lies 8  
miles south at Holland Lake!

## MISSOULA & KALISPELL

Located between Missoula (~85 miles) & Kalispell (~65 miles).

Both cities host International Airports & have excellent shopping.

The University of Montana is located in Missoula, along with the Missoula Children's Theater, Southgate Mall, a thriving downtown, and is located on Interstate 90. Kalispell is growing fast, and 15 miles further North, Big Mountain Resort in Whitefish.

Please note: The data contained herein was obtained from the owner and other reliable sources deemed reliable, but is not guaranteed. Prospective buyers are advised to check the facts to their own satisfaction.



## SWAN RIVER VALLEY REAL ESTATE

7217 HWY 83 N (Located in the Mission Mountains Mercantile Building)  
P.O. Box 1111 SWAN VALLEY, Condon, Montana 59826

**R** REALTOR  
MLS

Len Kobylenski, Broker - Swan Valley Office  
Phone 406.754.2233 Fax 406.754.2826  
Residential - Recreational - Investment

Website: [swanvalley.com](http://swanvalley.com) Email: [len@swanvalley.com](mailto:len@swanvalley.com)